

MIRAGE 2.0

Bronze Anodic Black 3000K/CRI80 Dali 200mm

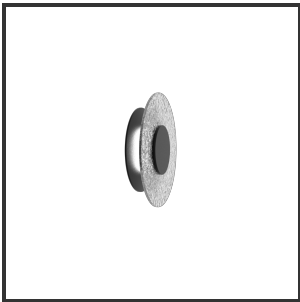

Beamangle	360°	Led type	SMD
Colour Deviation (SDCM)	3 sdcM	Lichtuittreiding	Indirect
Colour Temperature	3000K	Lumen/W out of the chip	125lm/W
CRI	80	Luminous flux of luminaire	1875lm
Dim	Dali	Material Housing	Aluminium & glas
Dimensions	Ø200x40	Material Lens/Reflector/Diffusor	Silicoon
Forward Voltage	25V	Max. connected Load	15W
Frequency	50-60Hz	Mounting Type	Wand
Glaskleur	Bronze	PF	0,9
Input current	200mA	UGR	<19
IP	IP20	Voltage	220-240V
Kleur		Weight	1,2kg

Reference : 000191731

Product Description